

**Contents:**

Page 2 - BoraBora 1-Person Details
Page 3 - Maldives 2-Person Details
Page 4 - Seychelles 4-Person Details
Page 5 - Warnings, Safety & Use
Page 6 - Control Panel Functions
Page 7 - Assembly & Installation
Page 8 - Assembly & installation

PRODUCT MANUAL

Personal Home Use Infrared Carbon Panel Saunas Made from Hemlock Wood and Tempered Glass Front and Door

Series HL-200 - ETL Approved and Listed

Products are approved and listed in compliance with the following standards;

UL 875:2009 Ed.9+R:26Jul2017

CSA C22.2#164:1991 Ed.1+G1



BoraBora
1- person



Maldives
2 - Person



Seychelles
4 - Person

3 - Year limited warranty applies

BoraBora - 1 Person Infrared Sauna



ETL Intertek Listed for use in the USA and Canada - Series HL-200

Approved and Listed in Accordance with;

UL 875:2009 Ed.9+R:26Jul2017

CSA C22.2#164:1991 Ed.1+G1

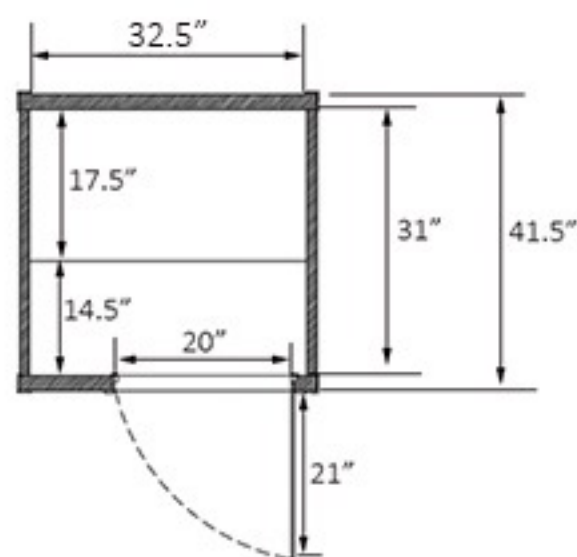

FEATURES: BoraBora Sauna

120v – 11.8 amps

Bluetooth compatible radio

Dual overhead speakers

Ozone sanitizing

Air purifier

Inside overhead light

Outside overhead twin lights

Chromotherapy light with direct control

Controls both inside and outside

One drink holder

One back infrared panel

Two side infrared panels

One under seat infrared panel

One floor infrared panel

One front infrared panel

Tempered glass front

MALDIVES - 2 Person Infrared Sauna



ETL Intertek Listed for use in the USA and Canada - Series HL-200

Approved and Listed in Accordance with;

UL 875:2009 Ed.9+R:26Jul2017

CSA C22.2#164:1991 Ed.1+G1

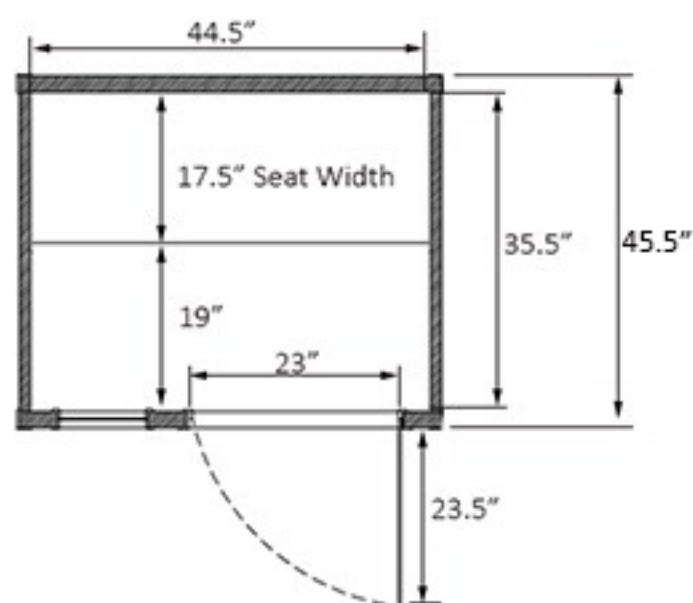
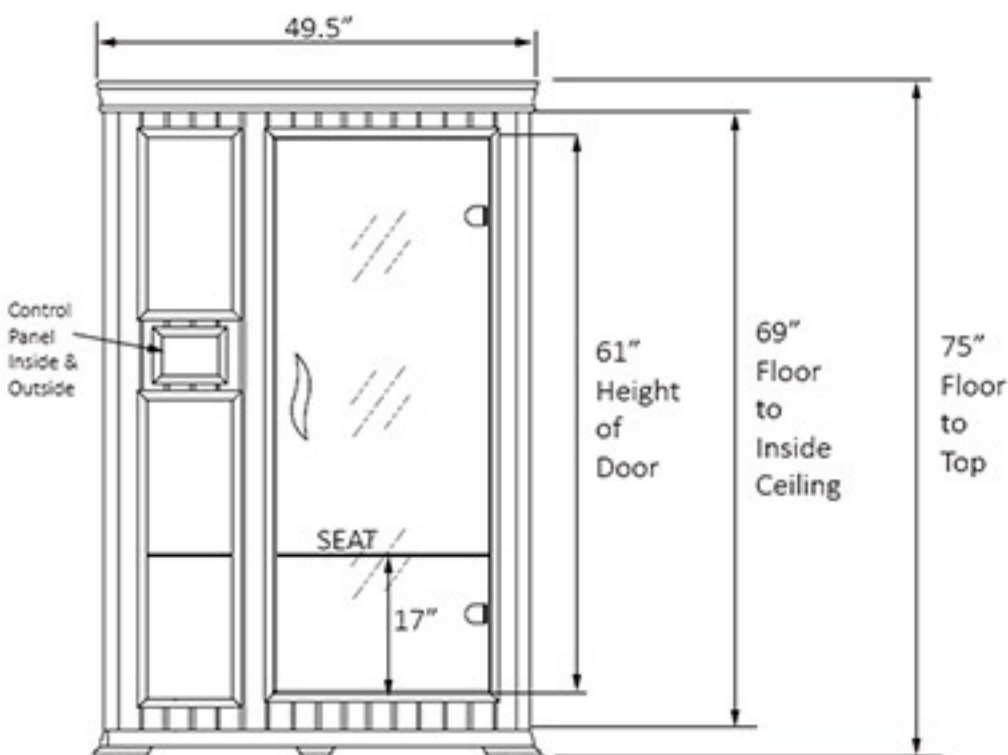

FEATURES: MALDIVES Sauna

120v – 15.5 amps

Bluetooth compatible radio

Dual overhead speakers

Ozone sanitizing

Air purifier

Inside overhead light

Outside overhead twin lights

Chromotherapy light with direct control

Controls both inside and outside

Two drink holders

One back infrared panel

Two side infrared panels

One under seat infrared panel

One floor infrared panel

Tempered glass front

Seychelles- 4 Person Infrared Sauna



ETL Intertek Listed for use in the USA and Canada- Series HL-200

Approved and Listed in Accordance with;

UL 875:2009 Ed.9+R:26Jul2017

CSA C22.2#164:1991 Ed.1+G1

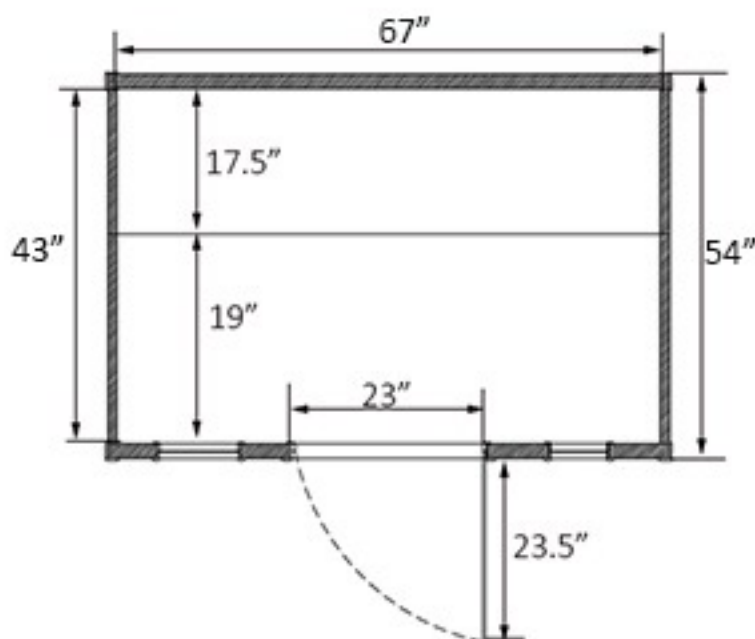
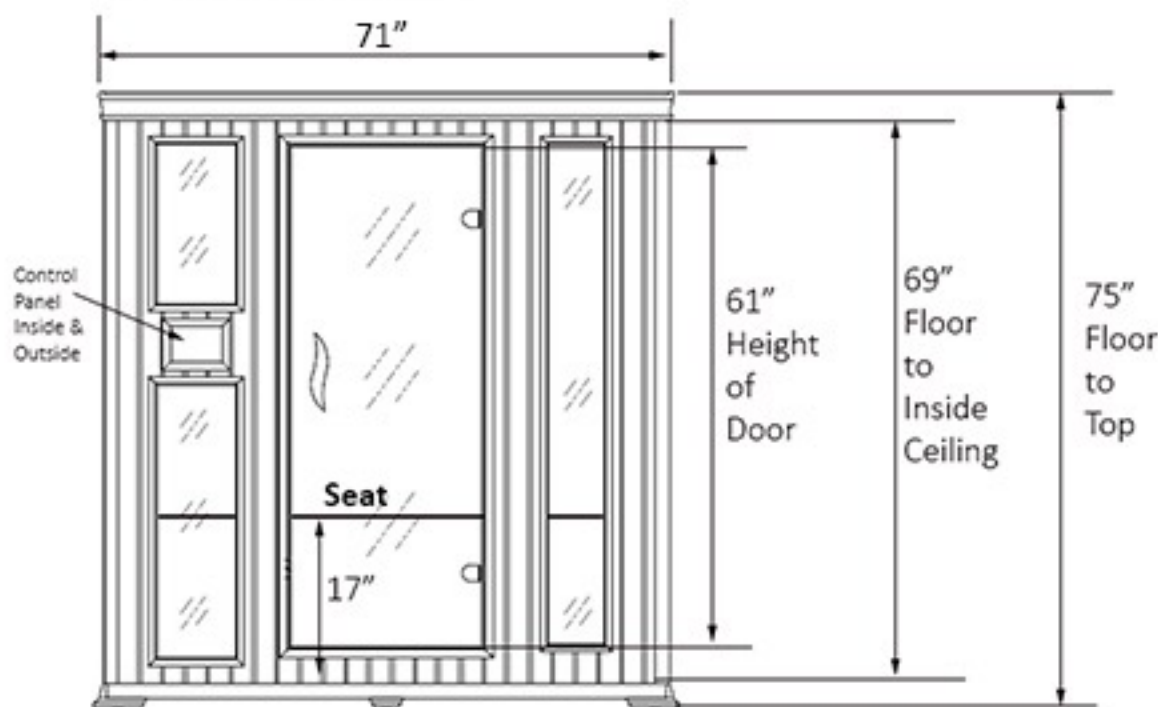

FEATURES: Seychelles Sauna

120v – 19 amps

Bluetooth compatible radio

Dual overhead speakers

Ozone sanitizing

Air purifier

Inside overhead light

Outside overhead twin lights

Chromotherapy light with direct control

Controls both inside and outside

Two drink holders

One back infrared panel

Two side infrared panels

One under seat infrared panel

One floor infrared panel

Tempered glass front

Personal Home Use Infrared Carbon Panel Saunas

Warnings, Safety and Use

Warning

People with pre-existing illness, medical conditions or a person on medication should consult their physician before using a sauna.

This sauna is not intended for use by persons with impaired physical, sensory or mental capabilities without the assistance and supervision of a qualified responsible person.

Children should only be allowed in the sauna with adult supervision.

If you start to feel dizzy during a sauna, remove yourself and call a doctor.

Risk of Burns

The infrared heating panels behind the slotted hemlock covers, do get very hot. It is recommended that you do not touch these carbon heating elements with your skin.

We incorporate a suitable number of slatted hemlock wood support over the carbon heating panels to assist in the prevention of your skin coming into contact with the carbon heating elements during normal use.

Safety and Use

Please read the manual before enjoying your first sauna.

Infrared saunas are most effective at a temperature of 140 degrees Fahrenheit.

However, entering the sauna while the temperature is lower will not have a negative effect.

While many experienced sauna users will spend over 30 minutes per session, it is recommended that for beginners, a 10 to 15 minute session will be best to develop and understand your personal body reaction.

During use, even at the full 140 degrees, it is common for no real sweat to occur until perhaps 5 minutes, sometimes longer. The sweat and the amount of sweat will depend on the individual.

Depending on the size of your sauna, it can take between 15 and 25 minutes to reach 140 degrees.

Personal Home Use Infrared Carbon Panel Saunas

Control Panel Functions



Main Control Panel

The inside and outside control panels offer the same functions.

Press power to start the sauna.

Above the power button are the lights in and out.

Set temperature up to a maximum of 140 degrees Fahrenheit.

Set timer to 60 minutes. It will start counting down from the moment it starts to heat.

For required sauna session time, adjust the timer before entering.



Inside Chromotherapy Light Control

Press the power button to choose the desired light color.

Press set when chosen

Adjust timer to required time and press set.



Air Purifier and Ozone Sanitizing

For air purification during session, press the left side of the button. The green light signifies the purifier is working.

For Ozone sanitizing when you have left the sauna, press the right button and the red light will come on to signify the Ozone is operating.

Do not stay inside the sauna when the ozone sanitizing red light is on.

It will automatically cut off after 15 minutes



MP3 Radio and Bluetooth

Press power to turn on.

Press Mode to connect to Bluetooth device

Press Band to select radio station

Personal Home Use Infrared Carbon Panel Saunas



Assembly & Installation (will require 2 people)

Figure 1



Place the base of the sauna on flat even surface. Ensure that the carbon heating element is at the front

Figure 2



Assemble the back panel with MP3 player to the base panel and at the same time attach the right-hand side panel.

Use the turnbuckles to hold them together.

As a double check, the side panels will always have the carbon heater nearer the back of the panel.

The assembly should now be standing on its own.

Figure 3



Connect the heated panel that holds the seat on top of the base and to the side panel.

It will fit snugly inside the two guide strips on the side panel.

The carbon heater will face towards the door

Figure 4



Connect the wires on the seat heater panel to the wires on the back panel

Figure 5



Position the seat on top of the under seat heat panel and the support on the back panel.

Don't screw it in place till after final assembly

Personal Home Use Infrared Carbon Panel Saunas



Assembly & Installation (will require 2 people)

Figure 6



Assemble the left hand side panel and connect all turnbuckles.

Make sure the assembly is now square.

Figure 7



Attach the front panel with the tempered glass door and tighten all turnbuckles.

Add the door handles.

Figure 8



Attach the roof and run all wires through the corresponding holes in the roof panel.

After all wires are run through, push the roof down and ensure it is properly seated.

Connect all wires that are clearly marked together.

Figure 9



Figure 10



Figure 11



Figure 12



Control panel in Figure 9, Purifier in Figure 10 and Seat in Figure 11 all have pre-drilled holes. Attach the wires where required and screw these to the appropriate panel. The cup holder in Figure 12 can be placed where you would like on any panel wall.

There is a roof cover that can be attached if preferred.

The roof and floor of the unit are not designed to be screwed to the sides.

Care should be taken when moving the assembled unit not to dislodge sides.