

## EXPOSED VALVE Final Assembly & Calibration

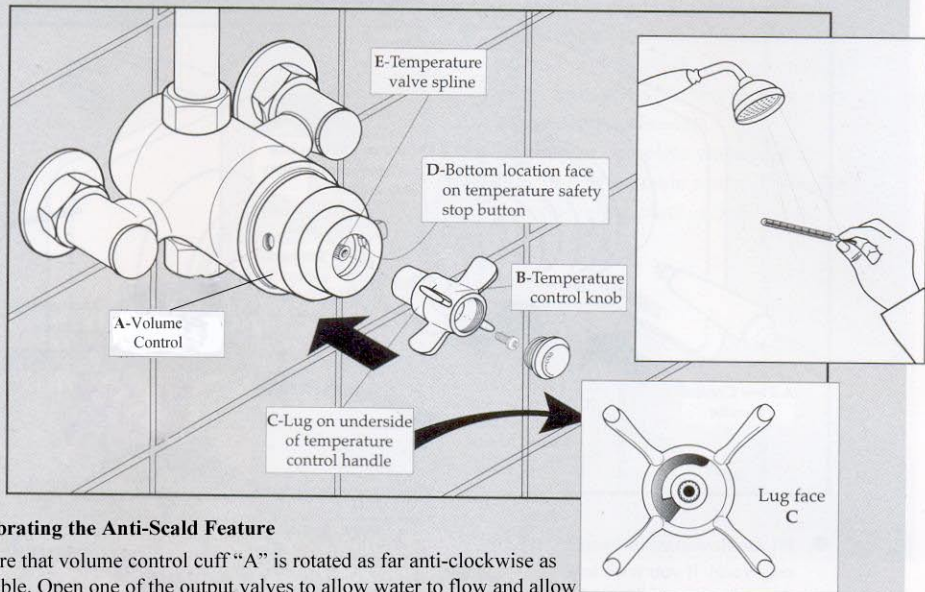

### Calibrating the Anti-Scald Feature

Ensure that volume control cuff "A" is rotated as far anti-clockwise as possible. Open one of the output valves to allow water to flow and allow time for the temperature of the water to stabilize. It will be necessary to leave the water running throughout the entire calibration. Measure the water temperature using a thermometer. If the temperature is not 38°C, the faucet will need to be adjusted to 38°C according to the instructions for calibration.

### Instructions for Calibration

Without attaching temperature control handle "B" using the screw, place it barely onto temperature control spline "E" so that the spline can be rotated using the handle, but not far enough onto the spline so that the stop on the underside of the handle "C" is able to catch on the safety button "D." It should be possible to adjust the spline freely in either direction using the temperature control handle "B." Alternatively, the spline can be adjusted directly using pliers, although care must be exercised to avoid damaging the spline.

### Adjusting Spline E

The spline must now be rotated in order to adjust the temperature of the water to 38°C. Turning the spline clockwise will reduce the water temperature whereas turning it anti-clockwise will increase the water temperature. Once the water temperature has been adjusted to 38°C, allow the water to run for 2 to 3 minutes so that the water temperature will stabilize. If the water temperature has changed after this time; repeat the adjustment of the spline.

### Attaching Temperature Control Handle B

When adjustment of the spline is complete, fit temperature control handle "B" all of the way onto spline "E" so that the stop on the bottom of the handle "C" is against the safety button "D," being careful not to accidentally rotate the spline. Tighten the handle onto the spline using the screw provided. The temperature control handle "B" should now be stopped by the safety button "D" at 38°C when rotated anti-clockwise. Temperatures above 38°C should only be possible by depressing the safety button "D."